

## Multipurpose Vessel



**Offshore Supply Vessel, handling, deck cargo**  
 Año 1980, rebuilt 2012 AMELIA LA, USA

### General information

Nombre	DogFish
Tipo de embarcación	Multipurpose Vessel
Built	1980/New Orleans USA
Rebuilt	2012
Owner	Z&P
Operador	Z&P
Bandera	Venezolana
Port of register	Maracaibo
Register number	AJZL- 33578
Call sing	YYV-6607

### Dimensions

Length O.A.	28 m
Beam	7.31 m
Depth	2.13 m
Maximun draft	3.04 m
Light draft	2.13 m
Clear Deck	15.24 x 6.10 m
Deck Area	92.96 m <sup>2</sup>
Deck Cargo	24 L. Tons

## Multipurpose Vessel

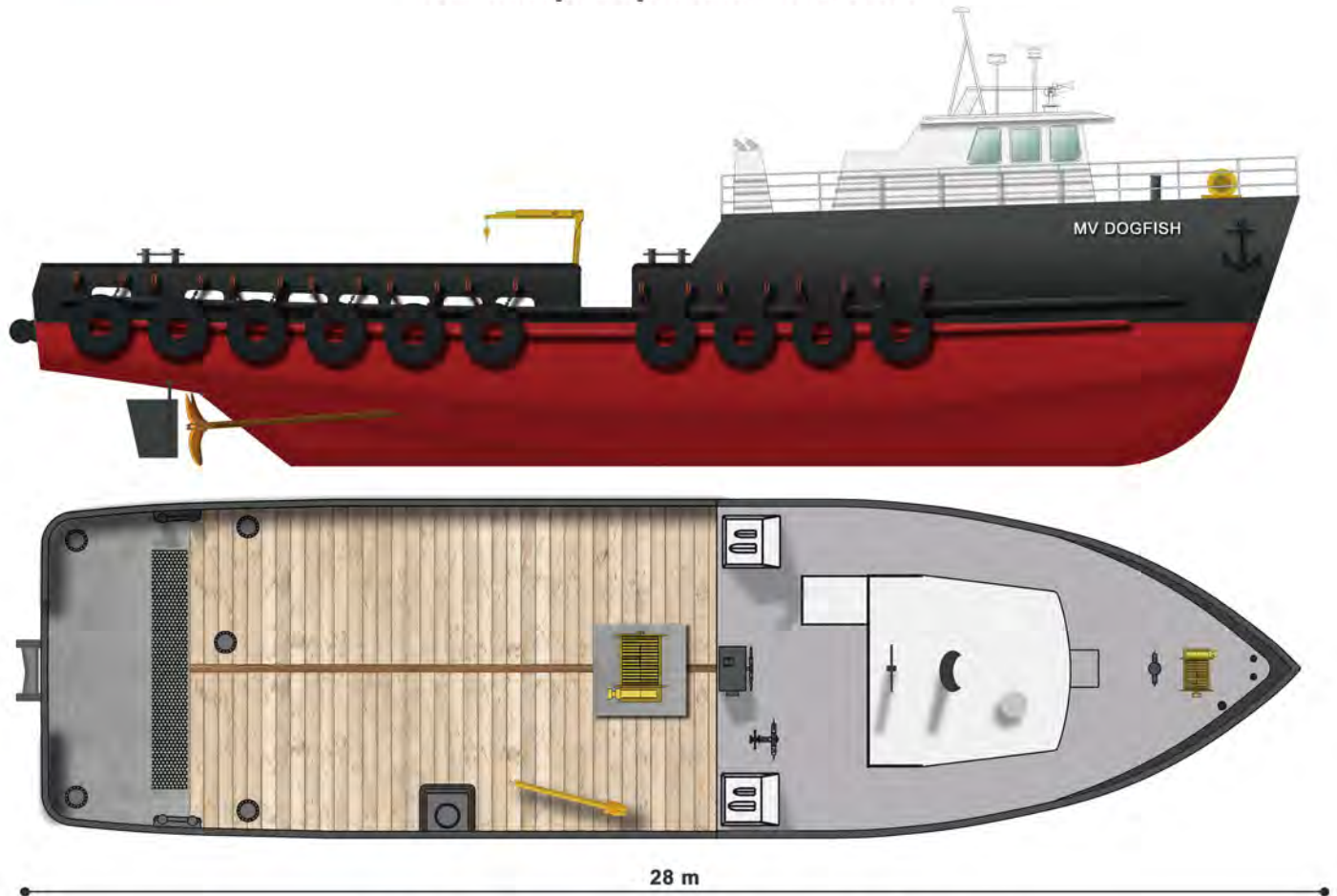

**Offshore Supply Vessel, handling, deck cargo**  
 Año 1980, rebuilt 2012 AMELIA LA, USA

### Tank Capacities

Fuel oil	50,786 lts. (13.400 gallons)
Fresh/Ballast water	38,658 lts. (10.200 gallons)

### Accommodation

Crew Size	04 persons
Passengers	12 persons
State Rooms	2
Total Berths	20

### Equipment

Anchors	01 750 lb, 01 500 lb
Windlass	Seahorse ES-750 10.000 lb max
Anchor/Towing Winch	Amclyde Frame 6 Hydraulic Driven Single Drum

### Propulsion System

Total power	720 Hp
Main engines	2 x Detroit Diesel 12V71 360 HP each
Gearboxes	Twin Disc MG 514 Ratio 4.13:1
Main generator set	2 x Detroit Diesel 3-71 30 Kw
Fire Fighting pump	6" Centrifugal pump DD 471
Emergency/ Work generator	Portable DPL70 HHLF Loadstar Perkins 1103A-33T62/ Marathon 62 kw
Propulsion	Two four blade fix pitch propellers 52" x 38"

### Nautical and communication equipment

Radar	#22 Sitix
Radios	Motorola 55/75 VHF Canadian Marconi
Magnetic compass	ES Ritchie and Sons
EPIRB	#ACR-14
Loudhailer	Raytheon

## Multipurpose Vessel

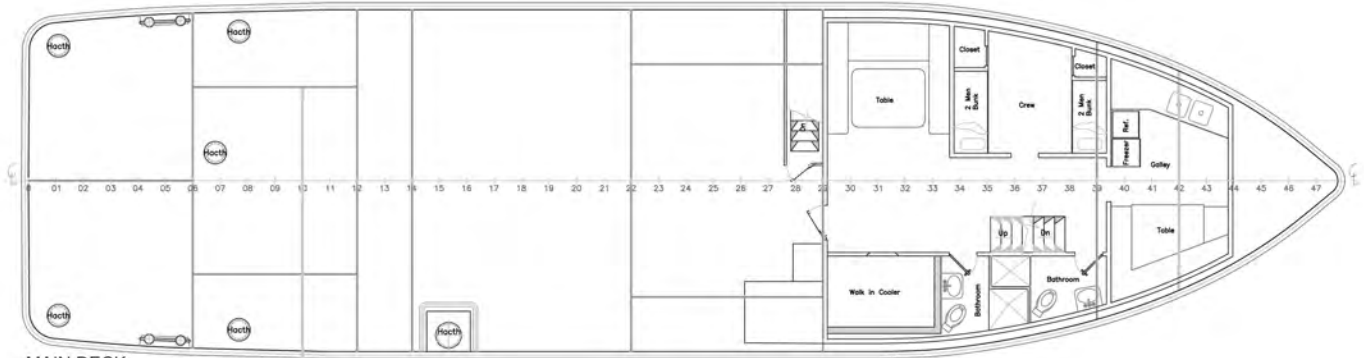

MAIN DECK

SCALE 1:50

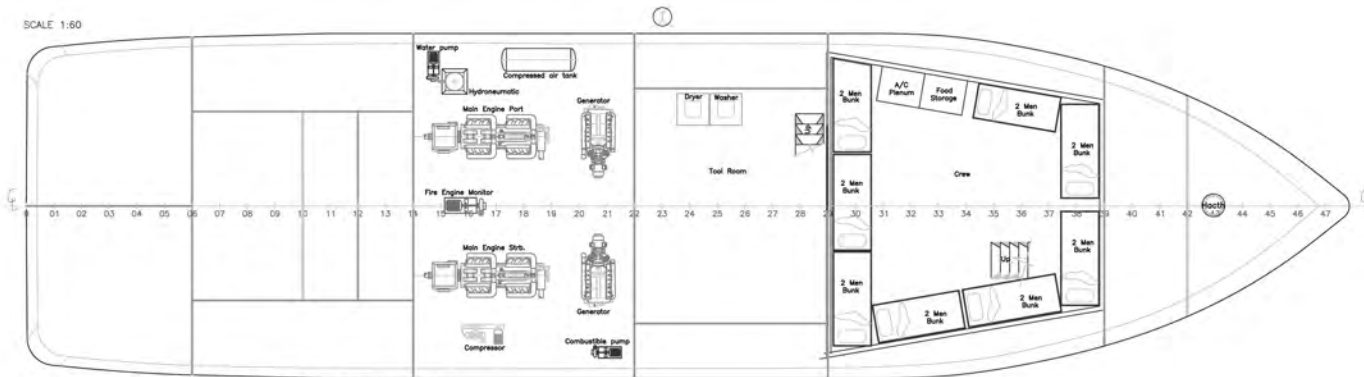

VIEW PLANT BELOW MAIN DECK (ENGINE ROOM)

28 m

**Offshore Supply Vessel, handling, deck cargo**  
 Año 1980, rebuilt 2012 AMELIA LA, USA



ZARAMELLA & PAVAN CONSTRUCTION Co, S.A.